**KUVS17-B**

Linear recirculating ball bearing unit

Schaeffler Kimliği:
0075638840000linear recirculating ball bearing units for
guideway with raceways on both sides

Teknik bilgiler

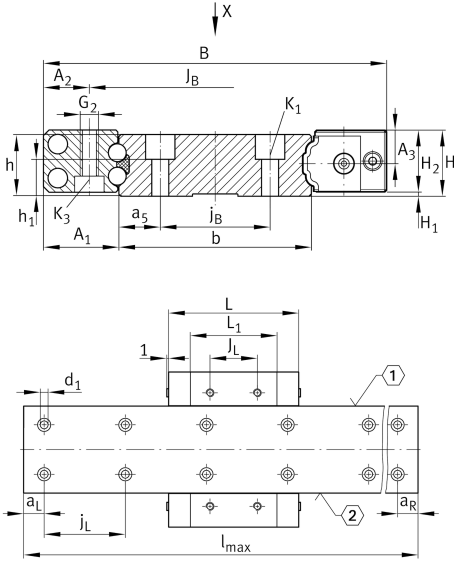

Main Dimensions & Performance Data

H	18 mm	Height sytem
B	116 mm	Width system
L	96 mm	Length linear recirculating ball bearing units
h	17 mm	Height rail
b	71 mm	Width rail
l_{max}	2.940 mm	Max. length rail
C	26.000 N	Load capacity dyn C
C_0	46.500 N	Load capacity dyn C0
M_{0X}	1.872 Nm	Moment ratings MOX
M_{0Y}	492 Nm	Moment ratings MOY
M_{0Z}	492 Nm	Moment ratings MOZ
$\approx m$	199 g	Ağırlık

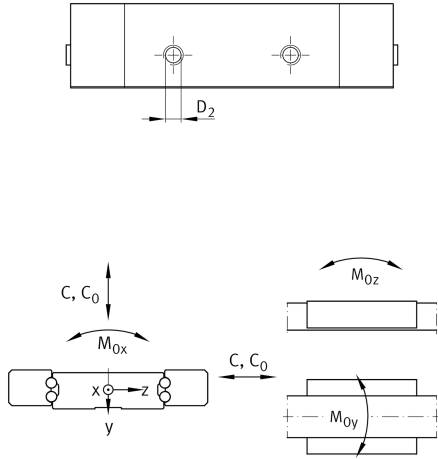

Mounting dimensions

A_1	22,5 mm	
A_2	13 mm	
J_B	90 mm	
j_B	50 mm	
a_5	10,5 mm	
L_1	64 mm	
J_L	35 mm	
j_L	60 mm	
a_{Lmin}	20 mm	
a_{Lmax}	53 mm	
a_{Rmin}	20 mm	
a_{Rmax}	53 mm	
H_1	0,5 mm	Free space, system dimension
H_2	17,5 mm	Height linear recirculating ball bearing units
A_3	9,5 mm	
h_1	8,3 mm	
K_1	M5	Thread
K_{1MA}	10 Nm	Tightening torque
G_2	M6	Thread
G_{2MA}	10 Nm	Tightening torque
K_3	M4	Thread
K_{3MA}	3 Nm	Tightening torque
d_1	6 mm	Diameter
D_2	4,9 mm	Diameter

Related products

TKVD71	Associated rail(s)
KA10-TN	Closing plug rail