**KUVS10-B**

Linear recirculating ball bearing unit

Schaeffler Kimliği:
0054000580000linear recirculating ball bearing units for
guideway with raceways on both sides

Teknik bilgiler

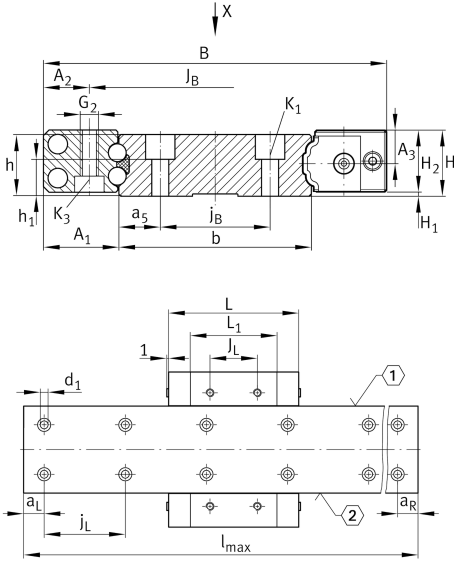

Main Dimensions & Performance Data

H	11 mm	Height sytem
B	51,6 mm	Width system
L	47 mm	Length linear recirculating ball bearing units
h	10 mm	Height rail
b	31,8 mm	Width rail
l_{max}	1.960 mm	Max. length rail
C	5.700 N	Load capacity dyn C
C_0	10.600 N	Load capacity dyn C0
M_{0X}	203 Nm	Moment ratings MOX
M_{0Y}	51 Nm	Moment ratings MOY
M_{0Z}	51 Nm	Moment ratings MOZ
$\approx m$	24,836 g	Ağırlık

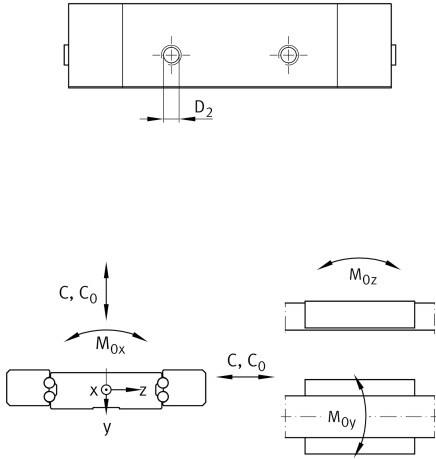
**Mounting dimensions**

A_1	9,9 mm	
A_2	5,5 mm	
J_B	40,6 mm	
j_B	18 mm	
a_5	6,9 mm	
L_1	29,8 mm	
J_L	15 mm	
j_L	40 mm	
a_{Lmin}	20 mm	
a_{Lmax}	34 mm	
a_{Rmin}	20 mm	
a_{Rmax}	34 mm	
H_1	0,5 mm	Free space, system dimension
H_2	10,5 mm	Height linear recirculating ball bearing units
A_3	6 mm	
h_1	3,4 mm	
K_1	M3	Thread
K_{1MA}	2,5 Nm	Tightening torque
G_2	M3	Thread
G_{2MA}	1,5 Nm	Tightening torque
d_1	3,8 mm	Diameter

Related products

TKVD32	Associated rail(s)
KA8-TN	Closing plug rail